

端子 TERMINAL

MARK	PLACES	ZONE	ECN	DATE

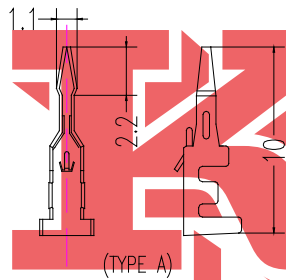

(TYPE A)

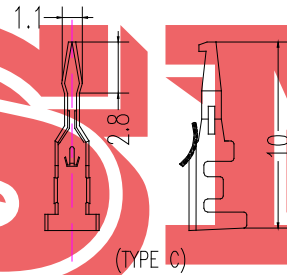

(TYPE C)

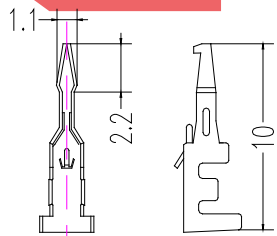

(TYPE B)

壳体 HOUSING

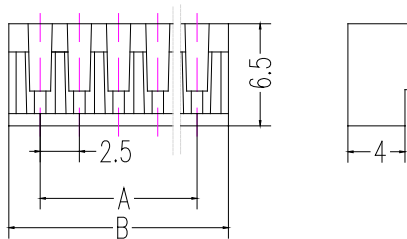

安装尺寸 MOUNTING MEASUREMENT

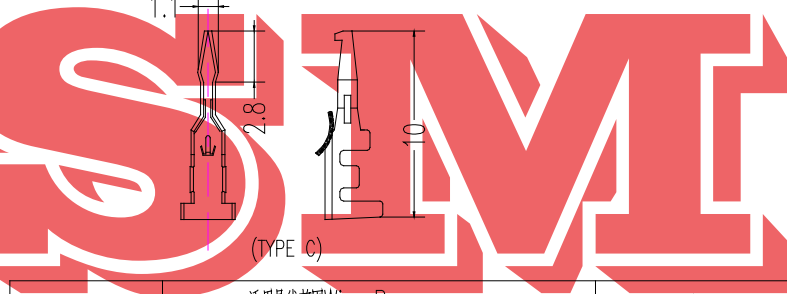
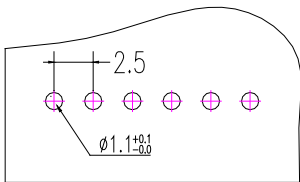

型号 Type	适用导线范围 Wire Range		导线外径 Wire Ins.Dis
	mm ²	AWG#	
SCN	0.08~0.33	28~22	0.9~1.7
材质、表面处理 Material and Finish			
磷青铜 phosph. bronze Tin.plated			

线数 poles	型号 Type	尺寸 Dimensions(mm)		线数 poles	型号 Type	尺寸 Dimensions(mm)	
		A	B			A	B
2	SCN-2A	2.5	6.5	10	SCN-10A	22.5	26.5
3	SCN-3A	5.0	9.0	11	SCN-11A	25.0	29.0
4	SCN-4A	7.5	11.5	12	SCN-12A	27.5	31.5
5	SCN-5A	10.0	14.0	13	SCN-13A	30.0	34.0
6	SCN-6A	12.5	16.5	14	SCN-14A	32.5	36.5
7	SCN-7A	15.0	19.0	15	SCN-15A	35.0	39.0
8	SCN-8A	17.5	21.5	16	SCN-16A	37.5	41.5
9	SCN-9A	20.0	24.0				

Shanghai ZhouRi Electronics., CO.Ltd.

Add: No.668 Beijing East Road

Tel: 86-21-51571121 53085565

Fax: 86-21-51571120

Http: www.ksmchina.com

E-mail: zhouri11@163.com

技术参数 (SPECIFICATIONS)

间距 (SPACE): 2.5mm

1. 适用线规 (Applicable wires): AWG28#~22#
2. 适用基板厚度 (Applicable PC board thickness): 1.2~1.6mm
3. 温度范围 (Temperature range): -25℃~85℃
4. 额定电压 (Voltage rating): 250V, AC, DC
5. 额定电流 (Current rating): 3A
6. 接触电阻 (Contact resistance): $\leq 0.01 \Omega$
7. 绝缘电阻 (Insulation resistance): $\geq 1000 M\Omega$
8. 耐压 (Withstand voltage): 1000V, AC/minute

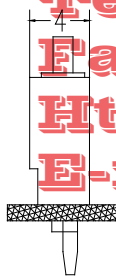

UNLESS OTHERWISE SPECIFIED TOLERANCE			(SCN) Pressure Welding Bar Connector		上海洲日电子有限公司 Shanghai ZhouRi Electronics CO.,LTD.						
DIMENSION	DECIMAL	ANGLE	MODEL NO.	间距 (Pitch): 2.5mm (.098")	MATERIAL	FINISH					
X.X	±0.1	±1°	DWG. NO.	ZR-Connector-007	COLOR	QUANTITY					
X.XX	±0.2	±0.5°	DESIGNED	Item NO.							
X.XXX	±0.1		CHECKED	REV.	A/O	SCALE	1:1	UNIT	mm	SIZE	A4
	±0.05		APPROVED	THE THIRD ANGLE PROJECTION			SHEET		OF	PAGES	